

SkyCAM 16M/12M Series

High Speed 16M Global Shutter Sensor Fit in C-Mount Lens.

- 16MP/12MP CMOS Sensor
- Compact C/CS-Mount for Cost-effectiveness
- Electronic Global Shutter with precise exposure control
- Support CameraLink Base and Full configuration
- Compatible USB3 Vision & GenICam
- Provide DK for Camera control / image acquisition
- Support pixel based flat field correction (FFC)



SkyCAM	AM	CL	EV	16M	40
Series SkyCAM=SkyCAM Series Highspeed Camera	Line/Area & Mono/Color AM = Area Scan Mono AC = Area Scan Color	Interface CL = Camera Link U3 = USB3	Sensor Brand EV = e2V	Pixel 16M = 16MP	Frame Rate 40 = 40fps

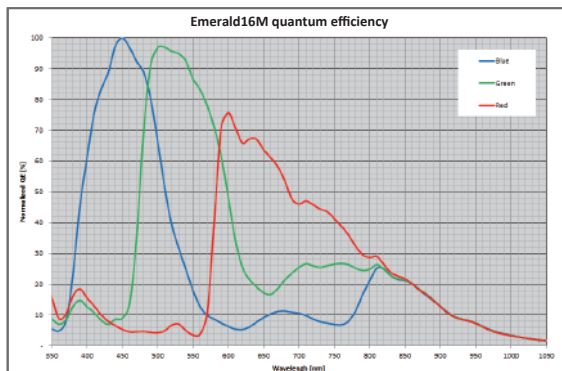

EV2S16M
Quantum Efficiency for Color Version

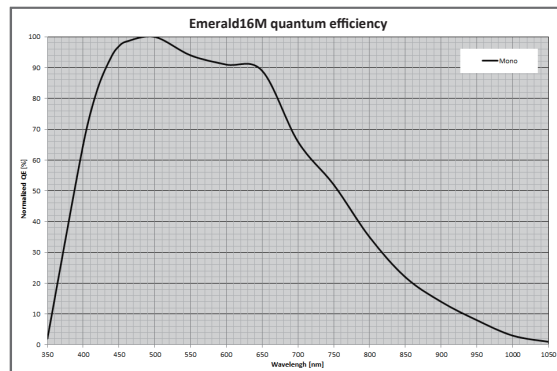

EV2S16M
Quantum Efficiency for Mono Version

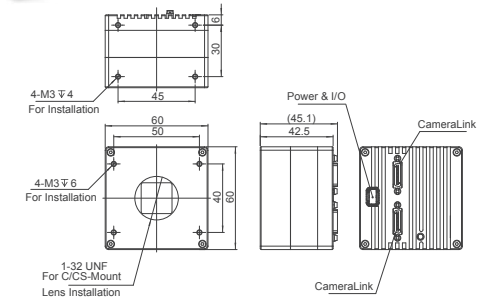

• SkyCAM AMCL - EV16M40 / EV16M23 / EV12M31
ACCL - EV16M10 / EV12M14

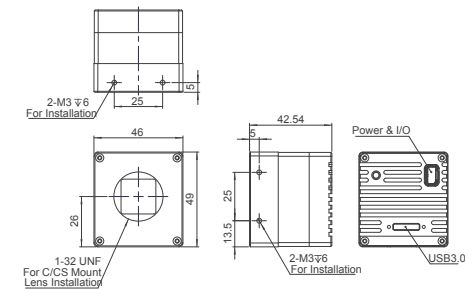

• SkyCAM AMU3 - EV16M22B / EV12M29B
ACU3 - EV16M22B / EV12M29B

Features / Model	SkyCAM AMCL-EV16M40	SkyCAM AMCL-EV16M23	SkyCAM ACCL-EV16M10	SkyCAM AMCL-EV12M31	SkyCAM ACCL-EV12M14	SkyCAM AMU3-EV16M22B	SkyCAM ACU3-EV16M22B	SkyCAM AMU3-EV12M29B	SkyCAM ACU3-EV12M29B
CMOS Sensor	Teledyne e2v Emerakd 16M High Speed	Teledyne e2v Emerakd 16M Standard Speed		Teledyne e2v Emerakd 12M Standard Speed		Teledyne e2v Emerakd 16M Standard Speed		Teledyne e2v Emerakd 12M Standard Speed	
Resolution (H xV)	4096 x 4096			4096 x 3072		4096 x 4096		4096 x 3072	
Pixel Size	2.8µm square pixels with shifted micro-lens					2.8µm square pixels with shifted micro-lens			
Sensor Technology/shutter	CMOS / Global Shutter					CMOS / Global Shutter			
Sensor Size (optical)	1 Inch					1 Inch			
Frame Rate	40 fps	23 fps	10 fps	31 fps	14 fps	22 fps	22 fps	29 fps	29 fps
Mono / Color	Monochrome	Monochrome	Color	Monochrome	Color	Monochrome	Color	Monochrome	Color
Video Output Format	Mono 8-bit	Mono 8-bit	Color 24-bit	Mono 8-bit	Color 24-bit	Mono 8/10	Bayer 8/10	Mono 8/10	Bayer 8/10
Output Interface	CameraLink SDR-26 x 2					Micro-B with Lock			
Output Standard	Mono Full 8 Taps @ 85MHz Mono Base 2 Taps @ 85MHz		RGB Medium 2 Taps @ 85MHz	Mono Full 8 Taps @ 85MHz	RGB Medium 2 Taps @ 85MHz	USB3 Vision			
Analog Gain	1 / 1.5 / 2 / 3 / 4 / 6 / 8x					1 / 1.5 / 2 / 3 / 4 / 6 / 8x			
Digital Gain	0.01~16x					0.01~16x			
Signal to Noise Ration	>39 dB					>39 dB			
Dynamic Range	> 55 dB @ 8-bit					> 55 dB @ 8-bit			
Synchronization	External Trigger / Software Trigger / Free Run					External Trigger / Software Trigger / Free Run			
Exposure Control	Programmable - 10.4µS ~ 10S	Programmable - 20.8µS ~ 10S				Programmable - 20.8µS ~ 10S			
Dimensions (L x W x H)	60 x 60 x 42.5mm (without lens adapter and connectors)					49 x 46 x 42.5mm (without lens adapter and connectors)			
Lens Mount	C-Mount / CS-Mount / M42-Mount					C-Mount / CS-Mount			
Digital Input / Output	2 Opto-isolated Input / 2 Opto-isolated Output					2 Opto-isolated Input / 2 Opto-isolated Output			
Power & I / O Connector	Hirose ix Industrial - IX80G-B-10P					Hirose ix Industrial - IX80G-B-10P			
Power Consumption (typical)	6.3W @ DC 24V Input					4.5W @ DC 24V Input, 3.9W @ USB 5V			
Weight (typical)	242 g					150g			
Operating Temperature	-20 to +60°C (housing temperature)					-20 to +60°C (housing temperature)			
Power Input	DC 9V~26V					DC 9V~26V			

